

Architecture

ARCHITECTURE | INTERIORS | LANDSCAPE

UPDATE AU



Re-bonding
mankind & nature p.41



text & photographs: courtesy, the architects

Orange Room

Perfect Generators Technologies Pvt. Ltd

New Delhi India Studio An-V-Thot Architects Pvt. Ltd., New Delhi, India



A 600-sq-ft space had to be converted into an Office to fit in eight junior workstations, two senior workstations, a conference, a reception and waiting area, a Principal Cabin with a library, a lounge to entertain guests, and of course a pantry with a small balcony as well as a toilet. The client needed endless storage capacity and splash of Orange Colour to match his company's product. The main concern was never to accommodate the brief but to accommodate in such a way that the openness as well as the free flow is not compromised.



Ankita Sweety graduated with a distinction in her Architectural Degree from NIT Patna and during the course won numerous National and State level Design Contests of repute. Since then she was associated with one of the leading design firms in New Delhi for two years. She is also a Visiting Faculty at an Architecture College in Gurgaon. She also holds the post of country' editing member for World Architecture Community.



Pratyosh Chandan worked with an established firm in Delhi for three years where-in he led various design projects of diverse nature, graduating in Architectural Technology & Construction Management from Rai University. He then went to UK to further pursue his architectural critique from University of Brighton, UK. The duo together created Studio an-v-thot with Ankita to provide design solutions.

In the year 2009, Architect Ankita Sweety & Pratyosh Chandan initiated "Studio An-V-Thot Architects Pvt. Ltd." a Design Consultancy firm in Delhi. The studio has taken up and completed several Architectural and Interior projects of varied nature, scale and sizes. An-V-Thot" is a hybrid of two words, (anvit) Sanskrit & (thought) English. "anvit" means followed by, so it is actually a studio followed by a thought.

Awards & Recognitions: Winners: Emerging Interior Designers of the Year: Era Fame Awards 2013.

The 100-sq.ft open area of 'Perfect Generators Technologies Pvt. Ltd., New Delhi, India' designed by Studio An-V-Thot Architects Pvt. Ltd greets visitors with warmth and fresh energy in the form of a perforated cave maximizing the depth of vision. The wallpaper to its left, and bamboos on a floating pebble bed add life to the whole ambience. A well cushioned, wall mounted waiting seat adds *panache* to it.

The interactive hierarchy based planning was adopted in such a way that the everyday story became prominent even before the office was made functional. The boss' cabin was overlooking senior work-stations, which in-turn were overlooking the junior work-stations while setting apart the movement pattern of employees, guests and owner. The lounge was adjoined to the Principal cabin providing partial blindness to the visitor' eye, while the Principal is able to see through the majority of workforce and reception area. The service area including pantry, toilet and balcony was kept at the rear to avoid disturbance as well as to maintain cleanliness throughout the office.

The design feature 'metal mesh' creates openness throughout the office. The mesh acts as a dividing line and a holder (holds multiple hanging storage units). The intention of using such mesh was to significantly nurture optimum and precise privacy levels for the adjoining spaces. This also leads to intertwined and interactive play of spatial volumes). Certain light fixtures when switched on exquisitely, cast a series of interesting shadow pattern.

The lounge & the Principal cabin are placed adjacent to each other, with a three channel sliding glass partitions to separate the two. As and when required they can be kept either open or closed so as to act as two different units or as one single large unit. An interesting book shelf, made using laser cut wooden jali and solid wood blocks is mounted on the wall. These blocks can easily be removed and re-placed in a manner to accommodate and display different size and faces of the books. To enhance the size of the cabin and the lounge, grooves in plaster were made, which run in a linear path at regular intervals. These are highlighted by painting the sunken surfaces with a dark colour (this helps to enhance the longitudinal length of the cabin as well as the lounge).





the light fixtures, casting a series of shadow pattern.



workstations.

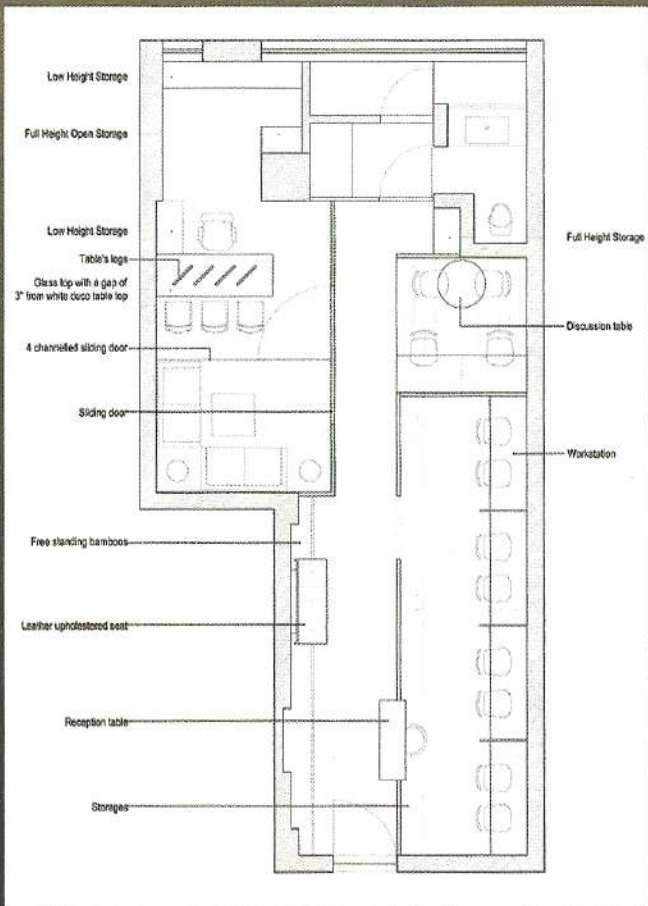

master plan

An interactive balance between warm and cool colours is achieved throughout the office space. The colour **Orange** symbolizes with the company product and can be seen through-out the ceiling. Other colours - green, blue, purple & grey are introduced at several areas to bring in the desired youthfulness as well as energy to the whole ambience.

A lot of highly glossy and reflective laminates as well as high-gloss PU pigment paint are used, which leaves the character of the body behind while enhancing the neighbouring skins leading to a better visual expanse. The impact of heaviness due to the large number of workstations is minimized by the use of light shaded wooden laminate. The intention to magnify the expanse is also achieved through the selection of fabrics with linear horizontal lines. Glass can be seen as an obvious choice while the *Wall of Jali* made out of laser cut MS plates refrains from blockage, while providing divisions. ▲

fact file:

- project : Perfect Generators Technologies Pvt. Ltd.
- location : New Delhi, India
- design team : Studio An-V-Thot Architects Pvt. Ltd.
- turnkey consultants : Mehta Enterprises
- site supervisor : Md. Mustaqeel Saifi
- area : 600 sq ft.
- duration : 45 days
- date of completion : February 2013
- photographs : Saptorshi Majumdar